

# CMI-TSCC122412N-SERIES

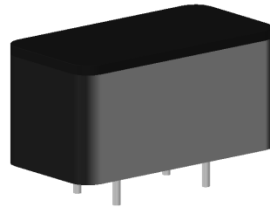

## Picture



## Features

- ▶ shielded construction
- ▶ Compact Size
- ▶ Multi channel type
- ▶ RoHS compliant

## Applications

- ▶ LED Drive Circuit, LED Buck Boost, Slim TV SMPS

## Dimension (Unit:mm)

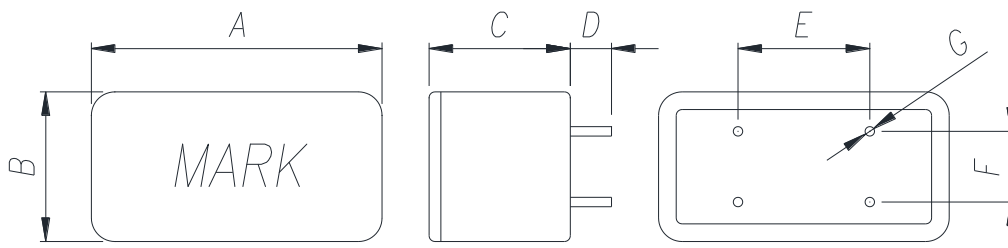

A	B	C	D	E	F	G
25.0 Max.	12.5 ±0.5	12.0 Max	3.5 ±0.5	11.2±0.5	6.0±0.5	0.8±0.1

## Schematic Diagram

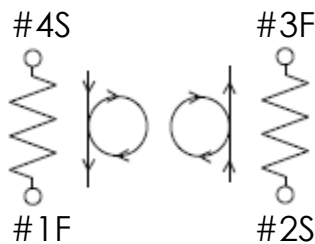

## Specifications

Part No.	Inductance ( $\mu$ H) $\pm$ 10%	DCR (m $\Omega$ ) Max.	Saturation Current(A)		Test Frequency (Hz)
			25 °c	100 °c	
CMI-TSCC122412N-801K	800	1200	1.20	1.10	100k
CMI-TSCC122412N-102K	1000	1700	1.10	0.90	100k

- Saturation Current : Depends on inductance saturation.  
(Inductance reduction from initial shall be under 20%)
- Test Condition : Temperature 20 °c  $\pm$  5 °c, Humidity 65%  $\pm$  20%

Ilisan Sales Office (KOREA) +82)31-904-1444  
 Shenzhen Sales Office (CHINA) +86)755-8663-6929  
 Hungary Sales office (EUROPE) +36)30-913-7706

H.K Sales Office (HONGKONG) +852)2711-5551  
 LA Sales Office (USA) +1)866-446-3586

▪ You can also contact us by e-mail : [coilmaster@coilmaster.com](mailto:coilmaster@coilmaster.com)

- All specifications are subject to change without notice.
- Update date : 2018.06.26

[www.coilmaster.com](http://www.coilmaster.com)