

SMD Power Inductors

CMI-SSP10L48F -SERIES

Picture



- Frequency Range: ~1MHz
- Inductance Range: 2.2~1000uH

Features

1. Available for reflow soldering
2. SMD magnetic shielded type of power inductor.
3. Suitable for power supply choke coil.
4. Available for Pb free soldering.

Dimensions (mm)

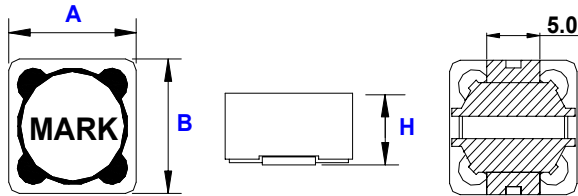

Series	A	B	H
CMI-SSP10L48F-SERIES	10.0 ± 0.3	10.0 ± 0.3	4.8MAX

Recommended Land Pattern

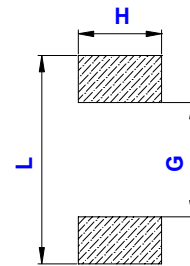

L(mm)	G(mm)	H(mm)
11	5.6	4.2

Specifications

Part Number	Inductance (uH)	DCR (mΩ) MAX	Rated DC Current (A)
CMI-SSP10L48F-2R2N	2.2 ± 30%	20	8.0
CMI-SSP10L48F-3R9N	3.9 ± 30%	30	7.0
CMI-SSP10L48F-4R7N	4.7 ± 30%	30	6.0
CMI-SSP10L48F-100M	10 ± 20%	48	5.0
CMI-SSP10L48F-150M	15 ± 20%	66	4.0
CMI-SSP10L48F-220M	22 ± 20%	90	3.5

- Measurement Frequency for Inductance: 100kHz
- Rated current is the value when the inductance is minus 20% from the nominal value at superposition.